



Creating a Better Future



TOUGH WORLD. TOUGH EQUIPMENT.

Liuzhou Liugong Forklift Co., Ltd.
No. 1 Yanghe Avenue, Yanghe Industrial
New Zone, Liuzhou City, Guangxi
Zip Code (P): 545006
Sales Hotline (T): 0772-2040713
Service Hotline (T): 0772-2040720/ 0772-2040721
E-mail (E): liugonglrs@liugong.com
Website (W): www.lgforklift.cn



Official website



Media Platform

Engine Xinchai
Fuel Diesel
Rated load 2000-2500kg
Rated Power 40 kW

CPCD20/25E
E SERIES INTERNAL COMBUSTION
COUNTERBALANCE FORKLIFT

TOUGH WORLD. TOUGH EQUIPMENT.

LG-PB-CPCD20/25E -0923EN

The Liugong series of logos herein, including but not limited to word marks, device marks, letter of alphabet marks and combination marks, as the registered trademarks of Guangxi Liugong Group Co., Ltd. are used by Guangxi Liugong Machinery Co., Ltd. with legal permission, and shall not be used without permission. Specifications and designs are subject to change without notice. Illustrations and pictures may include optional equipment and may not include all standard equipment. Equipment and options varies by regional availability.

PRODUCT DESCRIPTION

E series forklift products are a new generation of internal combustion counterbalance forklift products, newly developed by LiuGong according to market demand, used new industrial design and advanced technology, with green energy saving, reliable and stable, comfortable control, strong adaptability to working conditions.

RELIABLE AND STABLE

- Fully upgraded power system;
- Structural component strength upgraded;
- Steering system reliability upgraded.

NEW APPEARANCE

- Overall strong and more powerful;
- Counter weight with safety reflective label.



STRONG AND DURABLE

- Optimize the overall layout and improve the stability of heavy-load operation;
- Stronger and powerful Mast;
- Heavy duty steering axle.

COMFORTABLE

- Ergonomic layout;
- Small diameter steering wheel;
- LED high reliability lights.

PRODUCT KEY FEATURES

RELIABLE



Large flow air filter

- Low intake resistance, Strong engine respond;
- Filter radial and axial double seals, intake air is cleaner.



Sealed hood

- Engine hood installed with hidden;
- The rubber strip at the rear of the engine hood is always sealed, it can prevent tool and other object go into engineer compartment.



Integral steering column

- Steering column connect to Steering gear directly, operate force is small;
- The steering column is sealed structure, Dustproof and waterproof, it can be used in corrosion condition.

COMFORTABLE



Increase the anti slip pedal

- Anti-slip pedal is convenient to get on/off the truck and also more safe for the driver.



Comfortable ergonomics

- 300mm steering wheel, Relieve operation fatigue;
- Optimized layout of shift handle and hydraulic lever.



LED high reliability lights

- LED luminous light beads, with higher brightness;
- White cold light source, higher luminous efficiency, service life up to 20,000 hours;
- thin and light LED turn signal;
- rear combination light;
- high reliability.

STRONG AND DURABLE



Super stable mast

- Tilt cylinder support high position location, good stability;
- Large overlap distance of mast, deformation during heavy load operation is small;
- Standard configured with side bearing;
- Optional super high mast up to 6.0 m;
- The distance of bearing on carriage is big, it can reduce carriage vibration.

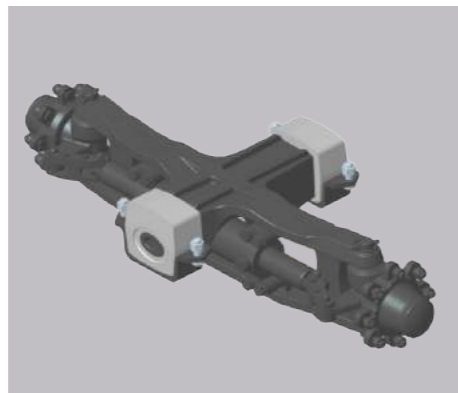

Heavy duty cast steering axle

- High strength axle housing;
- The steering knuckle adopted cylindrical roller bearing, Strong impact resistance;
- Installed with rubber damping, it can reduce vibration.



Reinforced frame

- 12mm fender with dual fender install hose;
- Integral stamping frame tail, structure is strong;
- High strength frame can meet the strength requirements of different attachment.

STANDARD SPECIFICATIONS

POWER SYSTEM

- xinchai c490BPG
- Integral cast damping steering axle
- Single filter
- Mid position exhaust

HYDRAULIC SYSTEM

- 2-funtion hydraulic valve
- Constant distribution steering hydraulic system

ELECTRICAL SYSTEM

- Maintenance-free battery
- LED head light
- LED front & rear combination light
- Horn
- Back-up alarm

MAST/ATTACHMENT

- 2 stage 3m mast
- 1040 carriage
- 1070 fork

OPERATION

- 300 mm steering wheel
- Integral steering gear
- Ordinary seat with seat belt
- Floor rubber mat

CHASSIS

- Hydraulic transmission
- Air tires
- 1070 fork
- Manpower hydraulic brake

AVAILABLE OPTIONS

POWER SYSTEM

- 2nd refined air filter (Fine filter)
- 2nd refined air filter (Oil filter)
- Mid position exhaust with Fire-proof cap
- High position exhaust
- High position exhaust with Fire-proof cap

ELECTRICAL SYSTEM

- Rear working light
- Cooling air conditioner
- Heater
- Warning light
- Area warning light (Left, right, rear)
- Blue spot light
- Reverse video
- Reverse voice alarm(English)
- Driving Recorder
- Travel speed limiter

MAST/ATTACHMENT

- 2 stage 2-5.0m mast
- 2 stage 2.7-4.0m FFL mast
- 3 stage 3.6-6.0m FFL mast
- 1220-2440 fork
- Optional wider carriage
- Side shifter
- Side shifter fork positioner
- Hinged broke handler
- Carton clamp
- Paper clamp
- Bale clamp
- Block clamp
- Push/Pull
- Single-Double pallet handler
- Fork sleeve
- Boom

OPERATION

- OVH guard (Shorter 100mm)
- Cab
- Semi-suspension seat
- Full suspension seat
- Three Rear view mirror

CHASSIS

- Electronic shift hydraulic transmission
- Solid pneumatic tire
- Dual air filled pneumatic tire
- Dual Solid pneumatic

Hydraulic system

- 3-Function control valve
- 4-Function control valve



MAST AND CAPACITY INFORMATION

Mast type	Maximum Fork Height (MFH)	Mast Overall Lowered Height (OAL)	Free Lift with Load Backrest*	Mast Tilt Angle (F/B)	Rated Load Capacity		Total Weight with Standard Forks	
					With Standard Forks			
					2/2.5T	2T	2.5T	2T
		mm		°	kg @ (500mm LC)		kg	
Standard 2-Stage	2000	1580	140	6 / 10	2000	2500	3285	3485
	2500	1830	140	6 / 12	2000	2500	3320	3520
	3000	2080	140	6 / 12	2000	2500	3355	3555
	3300	2230	140	6 / 12	2000	2500	3375	3575
	3500	2330	140	6 / 12	2000	2500	3390	3590
	4000	2630	140	6 / 6	2000	2300	3500	3700
	4500	2880	140	6 / 6	1920	2100	3605	3805
5000	3130	140	3 / 6	1660	1900	3710	3910	

Mast type	Maximum Fork Height (MFH)	Mast Overall Lowered Height (OAL)	Free Lift with Load Backrest*	Mast Tilt Angle (F/B)	Rated Load Capacity		Total Weight with Standard Forks	
					With Standard Forks			
					2/2.5T	2T	2.5T	2T
		mm		°	kg @ (500mm LC)		kg	
Full Free 2-Stage	2700	1930	830	6 / 12	2000	2500	3350	3550
	3000	2080	980	6 / 12	2000	2500	3385	3585
	3300	2230	1130	6 / 12	2000	2500	3405	3605
	3500	2330	1230	6 / 12	2000	2500	3465	3665
	4000	2630	1530	6 / 6	2000	2300	3530	3680

Mast type	Maximum Fork Height (MFH)	Mast Overall Lowered Height (OAL)	Free Lift with Load Backrest*	Mast Tilt Angle (F/B)	Rated Load Capacity		Total Weight with Standard Forks	
					With Standard Forks			
					2/2.5T	2T	2.5T	2T
		mm		°	kg @ (500mm LC)		kg	
Full Free 3-Stage	3600	1820	781	6 / 6	1800	2300	3580	3780
	4000	1950	911	6 / 6	1800	2150	3615	3815
	4300	2050	1011	6 / 6	1800	2100	3645	3845
	4500	2120	1081	6 / 6	1700	2000	3665	3865
	4700	2190	1151	6 / 6	1500	1900	3675	3875
	5000	2290	1251	3 / 6	1500	1800	3825	4025
	5500	2380	1341	3 / 6	1200	1500	4005	4205
	6000	2540	1501	3 / 6	900	1200	4055	4255

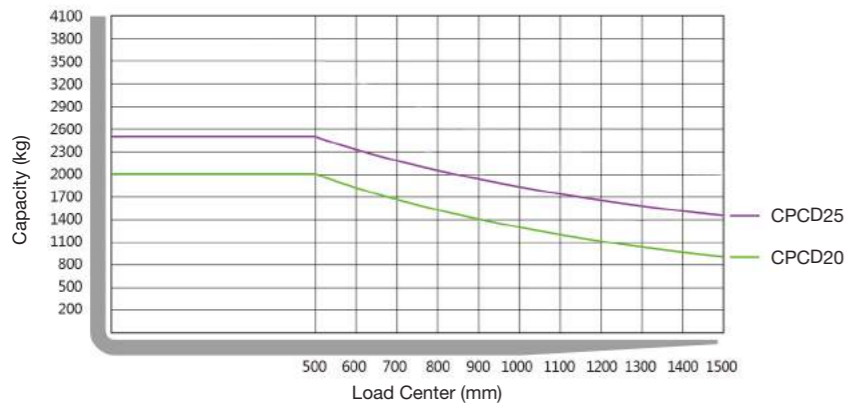

Note:
Vertical axle stands for load capacity while horizontal axle stands for load center, Load center is the distance counted from the front of the fork. The base point of the standard load is the center point of the cubic with the same 1000mm dimension in length, width and height. The load capacity should be down if mast tilt forward or using non-standard forks of loading goods with extra width. Please realize the different load capacity between different load centers according to load chart.

PRODUCT SPECIFICATIONS

Category	Item	Unit	CPCD20-E	CPCD25-E	
General	Model		CPCD20-E	CPCD25-E	
	Power Type		Diesel	Diesel	
	Base Capacity	kg	2000	2500	
Weights	Load Center	@ rated load center	500	500	
	Service Weight	unloaded	3370	3570	
	Axle Load	loaded/unloaded, front	4390/670	5300/760	
		loaded/unloaded, rear	1350/2020	1360/2210	
	Tire Type		Pneumatic	Pneumatic	
	Wheels	front / rear	2 / 2	2 / 2	
	Wheelbase		1650	1650	
Tires	Tire Size	front	7.00-12-12PR	7.00-12-12PR	
		rear	6.00-9-10PR	6.00-9-10PR	
	Tread Width	front/rear	960/970	960/970	
	Max. Fork Height	with std 2-stage mast	3000	3000	
	Freelift	with std 2-stage mast	140	140	
	Height, Upright Lowered	with std 2-stage mast	2070	2070	
Mast	Height, Upright Extended	with std 2-stage mast	4025	4025	
	Mast Tilt, Fwd/Back	with std 2-stage mast	6 / 12	6 / 12	
	Carriage	width	1040	1040	
	Fork Spread	minimum/maximum	272/1072	272/1072	
	Fork Dimension	T x W x L	40 x 122 x 1070	40 x 122 x 1070	
	Length to Fork Face	with std 2-stage mast	2500	2630	
Chassis	Overall Width		1150	1150	
	Overhead Guard Height		2100	2100	
	Turning Radius	minimum outside	2190	2230	
	Fork Overhang	with std 2-stage mast	476	476	
	Min.right angle stacking aisle width	add load length and clearance	3935	4015	
	Ground Clearance	center of wheelbase	110	110	
		loaded/unloaded	120	120	
Systems Performance	Travel Speed	loaded/unloaded	19/ 20	19/ 20	
	Lift Speed	loaded/unloaded	530/550	530/550	
	Lower Speed	loaded/unloaded	420/510	420/510	
	Max. Drawbar Pull	loaded	1680	1680	
	Max. Gradeability	loaded/unloaded	18/ 20	18 / 20	
	Brakes	service		Foot/Hyd	Foot/Hyd
parking			Hand /Mech	Hand /Mech	
Engine		manufacturer		Xinchai	Xinchai
		model		C490BPG	C490BPG
		emission compliance		CHN Stage II	CHN Stage II
		cylinders		4	4
	displacement	liter	2.67	2.67	
	rated power	kw/rpm	40/265	40/265	
max. torque	N.m/ rpm	160/1900	160/1900		

Engine	Xinchai C490BPG	Xinchai A498BT1	Xinchai A498BPG-558	Isuzu C240-NBKEG-01-C3	Yanmar 4TNE92-HRJ	Xinchai 4D27LPG	GCT GK25
	CHN Stage II	EU Stage IIIA	CHN Stage II	EU Stage III	EU Stage IIIA	N/A	N/A
	40/2650	36.8/2400	45/2500	35.4/2500	32.8/2450	41/2500	35.9/2300(LPG) 37.4/2300(GAS)
2.0t	●	○	○	○	○	○	○
2.5t	●	○	○	○	○	○	○

